

PNC-CUT

Tubing cutter, hole punch and insertion tool.

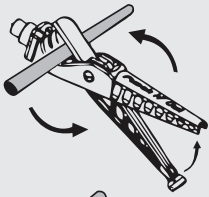

1

How to cut drip tubing or dripline

Lightly squeeze handles together while rotating them up and down. As the tubing is cut, release pressure at the end of the cut.

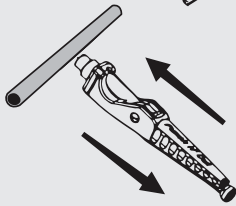

2

How to punch a hole into tubing

Place the tubing crescent against the tubing. Apply downward pressure until the punch pin pierces the tubing. Release. Periodically wipe the punch pin with your fingers to remove residual build-up.

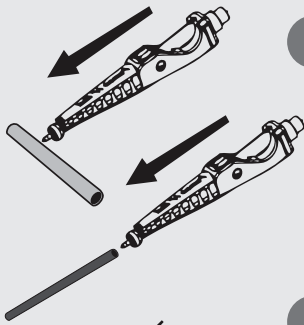

3

How to insert button drippers into 1/2" tubing and 1/4" micro tubing

Insert the dripper or barb into the upper barb holder. Place the dripper or barb against the punched hole in the drip tubing (or in-line end for 1/4" micro tubing). Apply pressure and insert the the drip emitter into the drip tubing. Remove the tool.

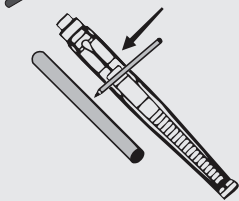

4

How to insert a dripper or barb with 1/4" micro tubing

Insert the dripper with 1/4" micro tubing attached into the small crescent slots on the bottom of the tool. Place the dripper on the outside edge of the tool with the 1/4" micro tubing pressed into the smaller crescents, and place the dripper barb against the hole in the drip tubing. Apply pressure and insert the dripper into the drip tubing. Remove the tool.

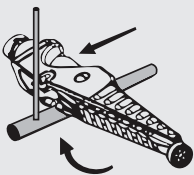

5

How to remove drippers from drip tubing

Place the tool's eased edge at the middle of the handle against the dripper at a 45° angle. Apply pressure until the dripper edge is lifted and seated into the tool crescents. While holding the dripper assembly in the crescents, rotate the tool backwards until the dripper is removed.



Warning!

Object is sharp – Use safety

1.800.344.2281 FAX: 760.727.0282

1210 Activity Drive
Vista, CA 92081
www.digcorp.com
e-mail: dig@digcorp.com

13-025 REV B 060217 © 2017 DIG CORP

 **DIG**[®]
water matters