

DIG CORPORATION THREE-YEAR WARRANTY

DIG CORPORATION warrants this packaged product to be free from defects in material and workmanship for a period of three years. Under this warranty DIG CORPORATION will repair or replace at no charge any of DIG products that fails in normal use within the warranty stated below.

This warranty does not cover damage resulting from accident, misuse, neglect, modification, improper installation or subjection to line pressure in excess of normal drip irrigation system operation. This warranty shall extend only to the original purchaser of the product for use by the purchaser. This warranty shall not cover any malfunction of the product if used with battery and due to battery failure. The obligation examination is found to contain defects in material and workmanship.

DIG CORPORATION SHALL IN NO EVENT BE LIABLE FOR ANY INCIDENTAL OR CONSEQUENTIAL DAMAGES OF ANY KIND; THE SOLE OBLIGATION OF DIG IS LIMITED TO REPAIR OR REPLACEMENT OF DEFECTIVE PRODUCTS. SOME STATES DO NOT ALLOW THE EXCLUSION OR LIMITATION OF INCIDENTAL OR CONSEQUENTIAL DAMAGES, SO THE ABOVE LIMITATION OR EXCLUSION MAY NOT APPLY TO YOU.

Unattended use for prolonged periods without inspection to verify proper operation is beyond the intended use of this product, and any damage resulting from such use shall not be the responsibility of DIG CORPORATION. There are no warranties, which extend beyond the description on the face hereof. In the case of purchase of the product for use other than, for irrigation purposes, DIG CORPORATION hereby disclaims any implied warranties including any warranties of merchantability and fitness for a particular purpose. In the case of the purchase of the product for personal, family or household purposes, DIG CORPORATION disclaims any such warranties to the extent permitted by law. To the extent that any such disclaimer or implied warranties shall be ineffectual, then any implied warranties shall be limited in duration to a period of one year from the date of the original purchase for use by the purchaser. Some states do not allow limitation on how long an implied warranty lasts, so the above limitation may not apply to you. In order to obtain performance under this warranty, the responsibility of the user is to returned the products to the factory, along with proof of purchase indicating original date of purchase, shipping prepaid, addressed as follows:

DIG CORPORATION, 1210 Activity Drive, Vista, CA 92081. Repaired or replaced units will be shipped prepaid to the name and address supplied with the unit returned under warranty. Allow four weeks for repairs and shipping time. Repair of damaged units not otherwise within warranty may be refused or done at a reasonable cost or charge at the option of DIG CORPORATION.

This warranty gives you specific legal rights, and you may also have other rights, which vary from state to state.

1.800.322.9146 FAX: 760.727.0282



1210 Activity Drive
Vista, CA 92081-8510

www.digcorp.com
dig@digcorp.com

Printed in the USA. We at DIG strongly believe in conservation.
Please recycle whenever possible. 051818 REV B 26-005



INSTALLATION INSTRUCTIONS

Drip and Soaker Vegetable Watering Systems

Models ST100AS

INTRODUCTION

Thank you for purchasing DIG Model ST100AS Drip and Soaker Vegetable Watering Kit. Please take the time to read through the enclosed instructions and to follow them step by step. If you have any questions, please call our customer service line at 1.800.344.2281. To automate the system, use DIG's B09D or EVO 100 Hose End Timer. Use this Vegetable Watering Kit to efficiently use water while maximizing the amount of water at the root zone, resulting in a healthy abundant crop.

INSTALLATION

The Drip and Soaker Vegetable Watering Kit can be installed easily either above or below the ground. It is designed mainly for use in vegetable gardens, but can easily be used for any row plantings.

Begin your installation at the water source by attaching the backflow preventer to the faucet. Next, insert the flow control and then the screen into the swivel adapter, and thread the swivel adapter into the backflow preventer. If the backflow preventer is not included, connect the swivel adapter directly to the faucet, and connect the compression side to the 1/2" poly tubing by pushing and wiggling the 1/2" poly tubing into the adapter end.

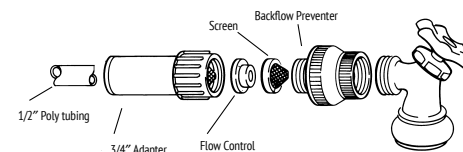

CONNECTING DRIP AND SOAKER TAPE TO 1/2" POLY TUBING

Option 1 - single row: Use #77 Connector to have one line of Drip and Soaker Tape. Connect the poly tubing to the compression side of the #77 Connector by pushing and wiggling the 1/2" poly tubing into the adapter end. Connect the Drip and Soaker Tape to the other end by turning the ring counter clockwise to expose the barb. Push the Drip and Soaker Tape over the barb, and thread the ring clockwise to lock in place.

Option 2 - multiple rows: Additional 1/2" poly tubing may be added to the enclosed 5' section and used as the main line running perpendicular to the vegetable garden rows. Near each row, punch a hole in the 1/2" poly tubing and insert the barbed end of the #29 Reducer into the 1/2" poly tubing. Connect the Drip and Soaker Tape to the other end of the #29 Reducer by turning the ring counter clockwise to expose the barb. Then, push the Drip and Soaker Tape over the barb, and thread the ring clockwise to lock in place.

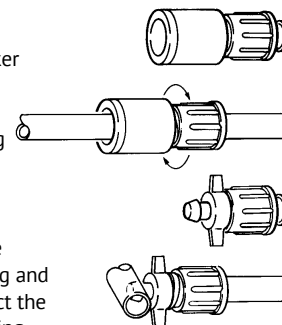

CONNECTING OR ENDING DRIP AND SOAKER TAPE

After connecting the Drip and Soaker Tape to the 1/2" poly tubing, we recommend flushing the system to make sure that all debris is flushed out before closing the end of the line. Flush the system by turning the water on for a minute or so, then close the ends of the poly tubing and the ends of the Drip and Soaker Tape by inserting the #28 Hose End into the Drip and Soaker Tape and pulling the ring forward to secure.

To connect two pieces of Drip and Soaker Tape together, use a #27 Connector by inserting the #27 Connector into the Drip and Soaker Tape and pulling the ring forward to secure.

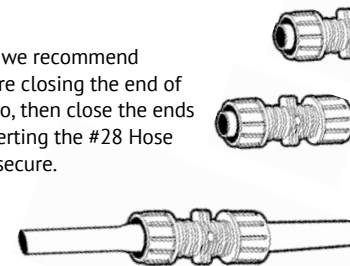

CONNECTING AND ENDING THE 1/2" POLY TUBING

After flushing the system, connect the end cap to the 1/2" poly tubing by pushing and wiggling the 1/2" poly tubing into the compression end. Make sure that the threaded end cap is tightened firmly.



1210 Activity Drive
Vista, CA 92081-8510

www.digcorp.com
dig@digcorp.com

Printed in the USA. We at DIG strongly believe in conservation.
Please recycle whenever possible. 051818 REV B 26-005



DRIP AND SOAKER HOSE LAYOUT WITH 1/2" POLY TUBING

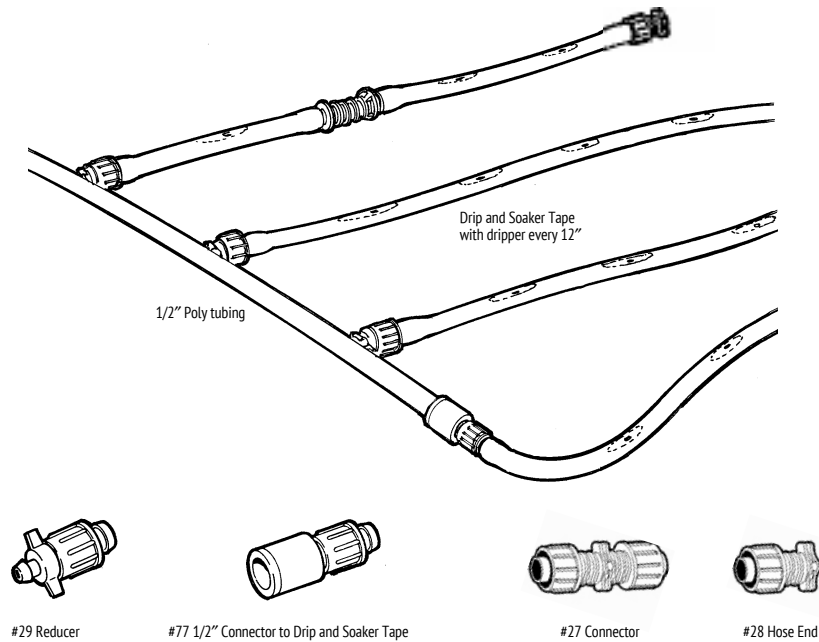

DIFFERENT LAYOUTS OF DRIP AND SOAKER TAPE

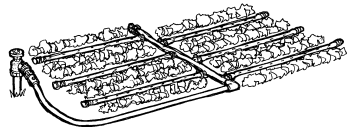

Installation method using the 1/2" poly tubing as the main line and the Drip and Soaker Tape installed between the rows or on each row using #29 Reducer.

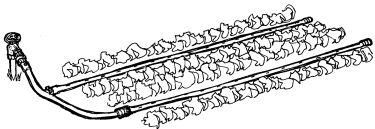

Installation method for two rows using #29 Reducer and #77 Connector, and the Drip and Soaker Tape installed between the rows.

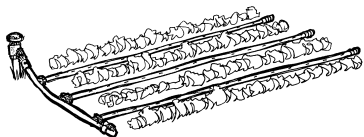

Recommended: Installation method using the 1/2" poly tubing as the main line and the Drip and Soaker Tape installed between the rows or on each row using #29 Reducer for multiple rows.

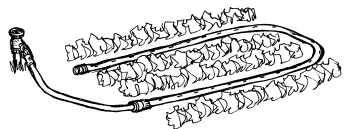

Installation method using the 1/2" poly tubing and the #77 Connector installed with one line of Drip and Soaker Tape. Using this method, the Drip and Soaker Tape can be used between the rows with a minimum requirement of 3' radius when making a curve. A 3' radius ensures water will flow through the Drip and Soaker Tape.

20' X 20' VEGETABLE GARDEN LAYOUT USING DRIP AND SOAKER TAPE WITH 1/2" POLY TUBING

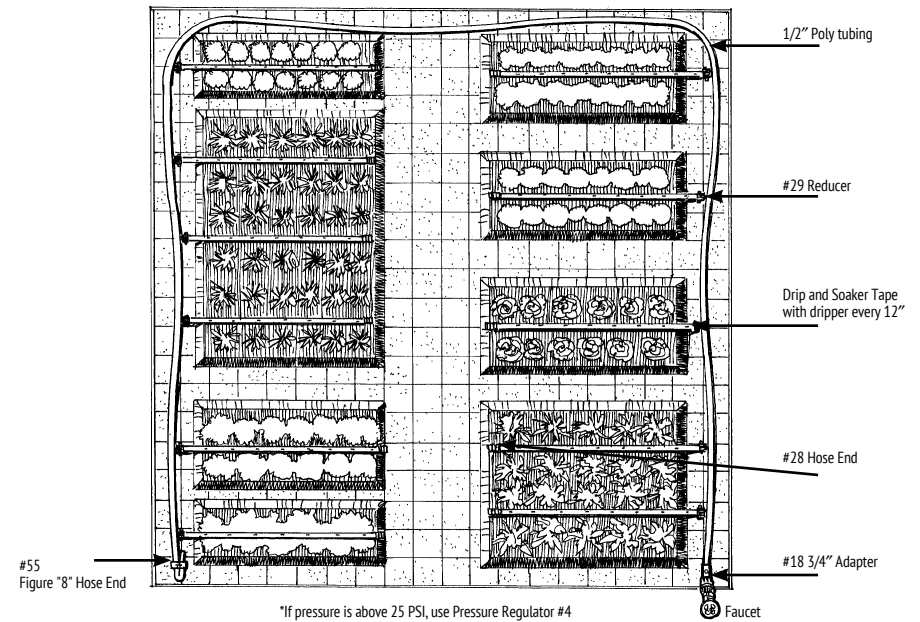

DESIGN TIPS

The flow control enclosed in this kit is used for runs of up to 100'. If you are expanding the kit with additional Drip and Soaker Tape, remove the flow control. If after removing, water pressure is above 25 PSI, add #4 25-PSI pressure regulator.

- If the rows are less than two feet apart, install one line of Drip and Soaker Tape between every two rows.
- If the rows are more than two feet apart, install the Drip and Soaker Tape on each row.
- A minimum of 3' radius is required when making a curve with Drip and Soaker Tape. This method is suggested when running one line of Drip and Soaker Tape every other row.
- A single line of Drip and Soaker Tape should not exceed 300' long.
- The recommended depth for burying the Drip and Soaker Tape is 4"-6" below the surface.

WATERING SCHEDULE

	Length of Watering	Hot	Warm	Cool
Vegetable Germination	1 hour	twice daily	once a day	every two days
Seedlings	45 minutes	every day	every 2 days	every 3-4 days
Producing Plants	1 hour	every day	every 2 days	every 3-4 days

Plants require different amounts of water depending on plant maturity, temperatures, wind and soil type. Use this chart as a guide, and your own experience to determine time and duration of watering.

We suggest reviewing your watering schedule every few weeks and making adjustments as needed.

KIT CONTAINS

- | | |
|---|---|
| (1) 100' of Drip and Soaker Tape | (1) Poly Tubing to Drip and Soaker Tape connector |
| (1) 5' of 1/2" Poly Tubing (50' coil sold separately) | (5) Drip and Soaker Tape Reducer |
| (1) Swivel Adapter with Screen and Flow Control | (1) Drip and Soaker Tape Connector |
| (1) Backflow Preventer | (5) Drip and Soaker Tape Ends |
| (1) End Cap for 1/2" Poly Tubing | (1) Punch |